

09/08/99

STATE	STATE PROJECT REFERENCE NO.	SHEET NO.	TOTAL SHEETS
N.C.	B-6034	RW01	05

STATE OF NORTH CAROLINA  
DIVISION OF HIGHWAYS

SURVEY CONTROL, EXISTING CENTERLINES,  
RIGHT OF WAY, EASEMENTS AND PROPERTY TIES

**JACKSON COUNTY**

LOCATION: BRIDGE NO. 490065 OVER SAVANNAH CREEK  
ON SR 1300 (PUMPKINTOWN RD)  
TYPE OF WORK: GRADING, DRAINAGE, PAVING, AND STRUCTURE

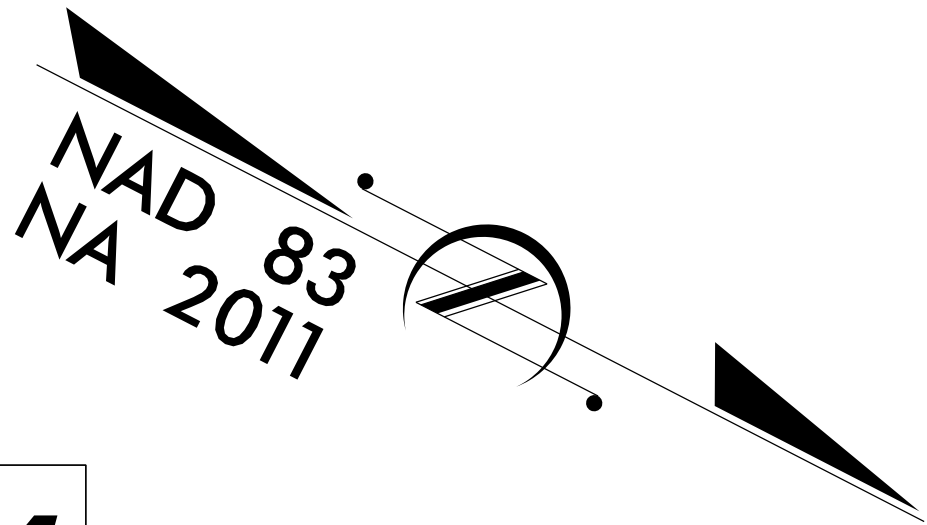

**RW04**

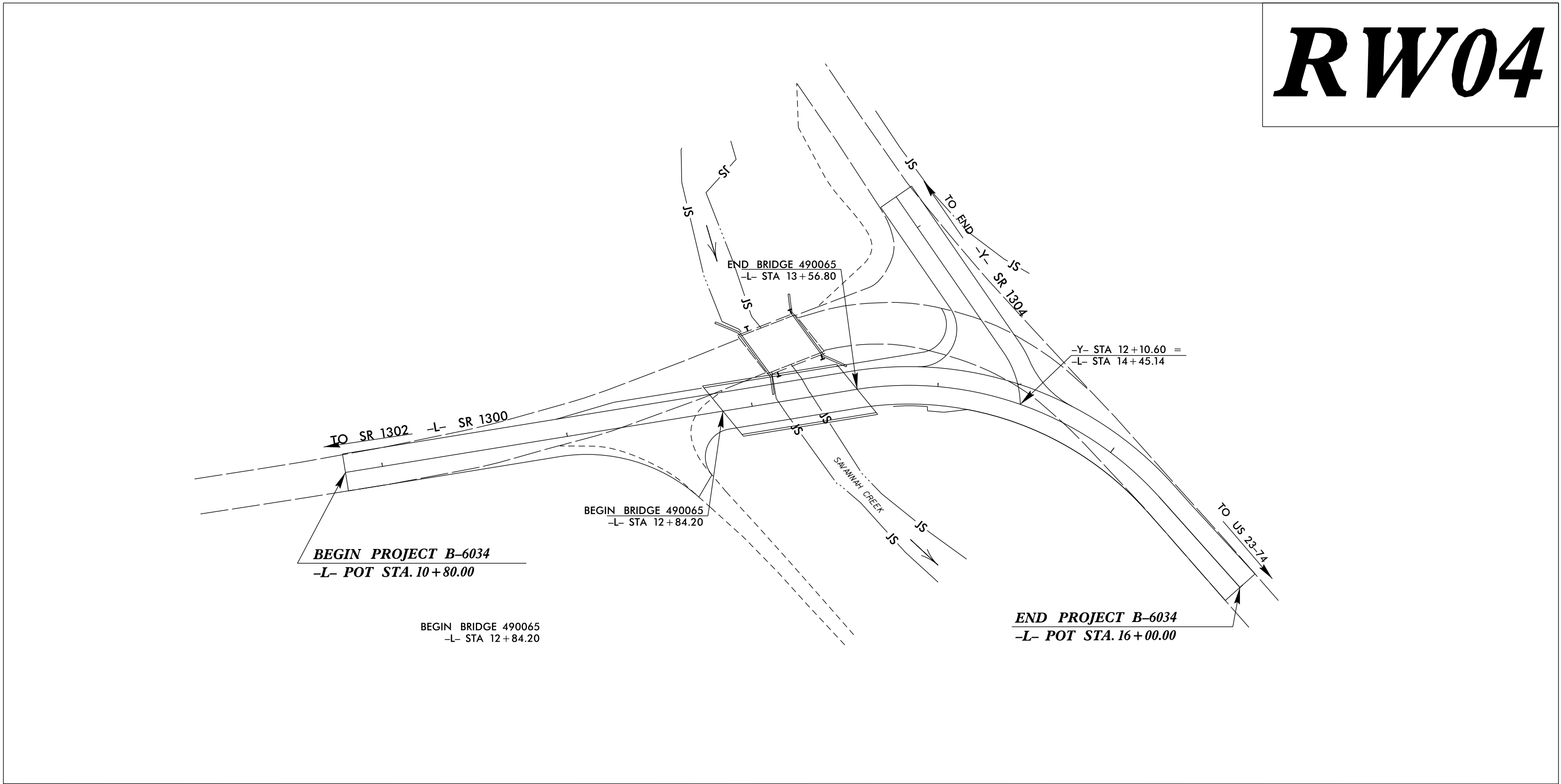

DOCUMENT NOT CONSIDERED FINAL  
UNLESS ALL SIGNATURES COMPLETED

**GRAPHIC SCALE**



**DATUM DESCRIPTION**

THE LOCALIZED COORDINATE SYSTEM DEVELOPED FOR THIS PROJECT  
IS BASED ON THE STATE PLANE COORDINATES ESTABLISHED BY  
NCGS FOR MONUMENT "GPS101"  
WITH NAD 83/NA 2011 STATE PLANE GRID COORDINATES OF  
NORTHING: 582,473.890(ft) EASTING: 720,150.827(ft)  
ELEVATION: 2,448.71(ft)  
THE AVERAGE COMBINED GRID FACTOR USED ON THIS PROJECT  
(GROUND TO GRID) IS: 0.99975981  
THE N.C. LAMBERT GRID BEARING AND  
LOCALIZED HORIZONTAL GROUND DISTANCE FROM  
"GPS101" TO -L- STATION 10+80.00 IS  
S 18°16'14.33" E 496.31(ft)  
ALL LINEAR DIMENSIONS ARE LOCALIZED HORIZONTAL DISTANCES  
VERTICAL DATUM USED IS NAVD 88

Prepared in the Office of:

LOCATION AND SURVEYS, DIVISION 14  
122 BONNIE LANE  
SYLVA, NC 28779

2018 STANDARD SPECIFICATIONS

RIGHT OF WAY DATE:  
AUGUST 5, 2024

LETTING DATE:  
FEBRUARY 10, 2026

PROFESSIONAL LAND  
SURVEYOR



DocuSigned by:  
*Brian Barnatt*  
A0305FE94BA0ACE  
SIGNATURE:

12/03/2025  
Date:

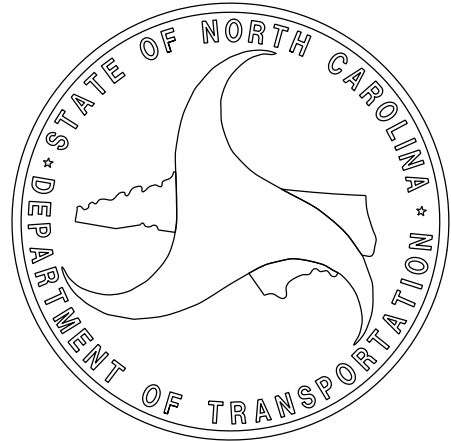

03-DEC-2025 14:12  
C:\Sylvia\Bridges\B6034\B6034\_RW\_Sheets\B6034\_ls\_rw01.dgn  
babar.watt AT LS-330173L